

HIDEAWAY RATCHET HINGE, PVD FINISH



Introducing the Hideaway Ratchet Hinge with a black Physical Vapor Deposition (PVD) coating. Not only is this ratcheting hinge versatile, robust, and concealed, but the PVD coating ensures a hard, weather-resistant finish that is more durable and longer lasting than traditional finishes.

Patent numbers US 8,875,347 and US 9,249,827

FEATURES & BENEFITS

- ▶ Stainless steel Type-304
- ▶ Smooth operation with multiple backrest positions
- ▶ Effortlessly return backrest to lounging position
- ▶ Three locking positions at 35°, 50° and 65°
- ▶ Easily modified to accommodate more or different angles by changing side plates
- ▶ Mounts to edge of bulkhead with the majority of hinge below deck
- ▶ Easily add independent operating backrests
- ▶ For cushions 3" to 3-1/2" thick
- ▶ Can be used for seat backs up to 20"
- ▶ Single seat capacity
- ▶ 500-hour ASTM B117-16 salt fog
- ▶ This hinge exceeds the strength requirements specified for seat backs in ABYC H31.9.2.

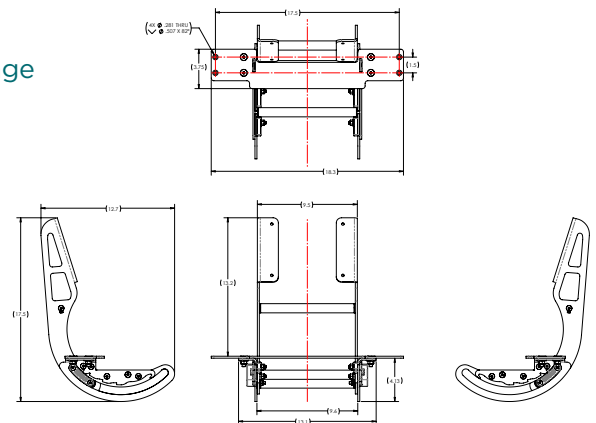

PVD COATING

- ▶ Provides an extra layer of protection against corrosion
- ▶ PVD coating can be applied in various colors for OEM
- ▶ This coating is a greener choice than other coating processes because it doesn't produce any gases or water waste, and it doesn't limit the recycling value of stainless steel
- ▶ PVD coating is hypoallergenic
- ▶ PVD coating maintains its color and luster over time

PART NUMBER	DESCRIPTION	UOM
H25-0042PVD-M	Hideaway Ratchet Hinge, PVD Finish	Each